

SPECIFICATIONS:

1. ELECTRICAL CHARACTERISTICS:
 - 1.1. RATING: 3A;
 - 1.2. CONTACT RESISTANCE: 30 mΩ MAX. (INITIAL);
 - 1.3. DIELECTRIC WITHSTANDING: 100V AC MIN.;
 - 1.4. INSULATION RESISTANCE: 100MΩ MIN.;
2. DURABILITY: 10,000 CYCLES MIN.;
3. INSERTION FORCE: 5-20N;
4. EXTRACTION FORCE: 6-20N;
5. WATER PROOFNESS: THIS PRODUCT IS BASED ON IPX6.
6. PLUG INTERFACE DIMENSIONS COMFORM TO USB2.0 SPEC.
7. PACKAGING: TAPE & REEL.

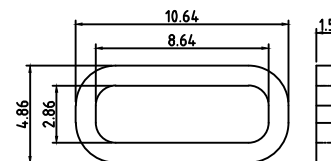

建议胶圈尺寸

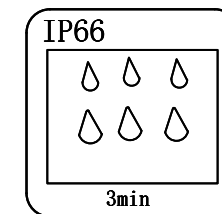

3	Shell	1	SUS304R-1/2H Ni Plating T=0.25mm	
2	Contact	6	Phosphor bronze C5191R-EH Au/Ni Plating T=0.20mm	
1	Housing	1	PA10T (G.F30%)	
ITEM	PART NAME	Q' TY	FINISH	NOTE

CUSTOMER DRAWING

UNITS mm	SCALE 1:1	SHEET 1 OF 1
PROJECTION: 	DRAW: DAP	
GENERAL TOLERANCE	CHECK: HWT	
.000 ±0.20	APPD: HHM	
.00 ±0.30		
.0 ±0.50		
.0 ±2°		
.00 ±1°		

铭创科技（东莞）有限公司
Mingchuang Technology (Dongguan) Co., Ltd.

TITLE
防水TYPE C母座6PIN 板上四脚插板SMT L=7.85 全塑

MAT'L
SEE TABLE FINISH
SEE TABLE

DWG. NO. B09W0603A PART NO. _____ SIZE
A4

A5	CC1	B12	GND
A9	VBUS	B9	VBUS
A12	GND	B5	CC2
PIN	SIGNAL NAME	PIN	SIGNAL NAME

REV	DESCRIPTION	DATE	APPROVED
A	新版发行	2020.11.06	HHM